

**SLOT NOZZLE – RIBBON APPLICATOR**

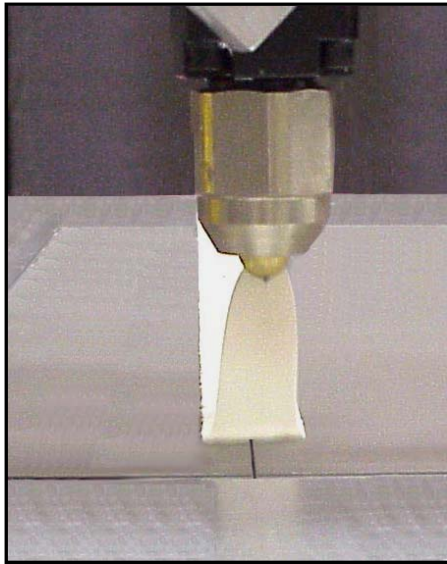

**1208-206-.020 Slot Nozzle  
Applying PVC Seam Sealer**

- **Ribbon Applicator**
- **Reduces Material Usage**
- **Machined Flats Assures Repeatabile Nozzle Alignment**
- **Consistent Placement Of Material**
- **Nozzles With Various Orifices**
- **Carbide Nozzle Provides Abrasion Resistance**
- **High Volume Flow Thru Design**
- **Adapts To A 2200-245-130-AA w/Nozzle Alignment Slots**

The new slot nozzle provides a repeatable ribbon of material for both adhesives and sealers. When robotically applied the slot nozzle design dispenses a thin, consistent ribbon of material onto the part or substrate. The thickness of the ribbon is based on the tool tip speed of the robot and the slot cut gap. The width of the ribbon is based on the flow rate of the material.

The slot nozzles were designed for PVC plastisol automotive seam sealing applications. In addition the slot nozzle is used in many industries, in place of circular beads, for the benefit of dispersion of adhesives over a wider area, before assembly.

The nozzle's carbide design affords extended working life even with the most abrasive materials.

The nozzle has (2) flat sides that were designed to make orientation of the slot repeatable. This will then eliminate the need to align the nozzle to a calibration gauge and saves valuable production time. When necessary the nozzle can be replaced in under one minute and production is back up and running.

The carbide nozzle is available in a variety of slot cut gap (see Page 2). Contact us for details.

**45677 Helm Street • P.O. Box 701460 • Plymouth, MI 48170-0965 • USA**

**Phone: (734) 459-8600 • Fax: (734) 459-8686**

**E-mail: [dispensevalves@sealantequipment.com](mailto:dispensevalves@sealantequipment.com) • web: [www.dispensevalves.com](http://www.dispensevalves.com)**

# 1208-206 Series Slot Nozzle

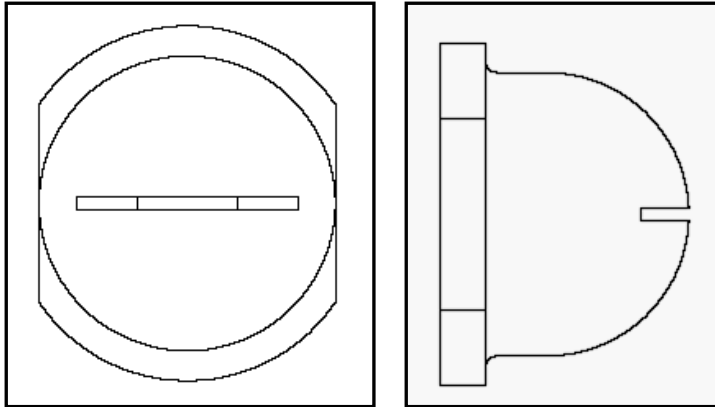

**The Flats on the Nozzle Assure  
Correct Orientation of Nozzle**

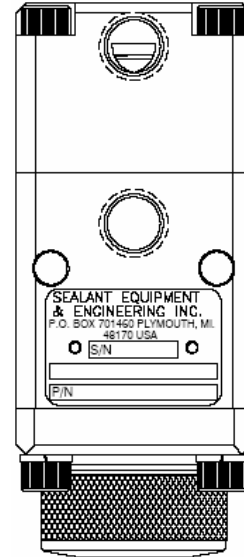

**1208-206-.0XX Slot Nozzle is Designed  
to fit the 2200-245-130 Valve (Above)**

| -SIZE |
|-------|
| .013  |
| .014  |
| .016  |
| .018  |
| .020  |
| .026  |
| .030  |
| .032  |
| .033  |
| .034  |
| .035  |
| .036  |
| .037  |
| .038  |

**The 1208-206-.0XX  
nozzles are available in a  
variety of slot cut gaps**

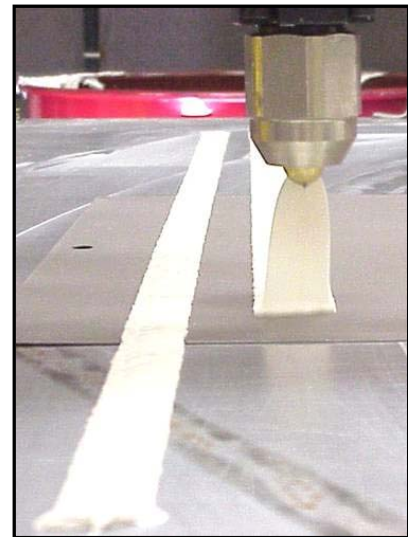

**1208-206-.0XX Slot Nozzle Applying  
A 18mm & 25 mm Ribbon of Sealer**

Form 206-0507 • Copyright 2005



Manufacturers of Precision Dispense Systems & Valves

45677 Helm Street • P.O. Box 701460

Plymouth, MI 48170 • USA

Phone: (734) 459-8600

Fax: (734) 459-8686

Web: [www.dispensevalves.com](http://www.dispensevalves.com)

E-mail: [dispensevalves@sealantequipment.com](mailto:dispensevalves@sealantequipment.com)